



Buffalo Academy of the Sacred Heart

Driving Permission Slip 2016-2017

Students are permitted to drive to Sacred Heart Academy. They must use the designated parking areas in the Key Bank parking lot and must abide by the following rules:

- ☞ Students may not loiter in/on/around the cars before, during or after school.
- ☞ Students may **ONLY** park in the designated areas on either side of the area around the "F" pole to the back of the lot.
- ☞ The Main Office will issue students a parking sticker that must be displayed in the window of the vehicle they are driving to school. If you are registering 2 vehicles, you will receive a parking sticker for each vehicle. If a parking sticker has been lost a new sticker will be issued at a cost of \$5.00. **A new parking sticker must be applied for each school year.**

Please note the following as requested by Key Bank and Sacred Heart Academy:

- ☞ Parking is only permitted in Sacred Heart spaces only (see attached map).
- ☞ Students and parents are to enter and exit the parking lot from the Main St. entrance near Sacred Heart or the Eggert Rd. entrance at the North end of the parking lot near the Cantalician Center.

Do not use the Eggert Rd. entrance closest to Main St. This entrance is for Key Bank use only.

- ☞ While in the parking lot, drive only in the roadway in front of the school and along the fence at the rear of the parking lot. Cutting across open parking spaces is not allowed under any circumstances.
- ☞ The speed limit while in the parking lot is **10 mph**. Please adhere to this at all times.
- ☞ Follow all other posted traffic signs in the parking lot.
- ☞ Report any issues or parking lot incidents immediately to the SHA Main Office.
- ☞ A STUDENT'S PRIVILEGE TO PARK IN THE LOT WILL BE REVOKED IF SHA FAILS TO FOLLOW THE ABOVE PARKING RULES, HER DRIVING/BEHAVIOR IN THE LOT IS INAPPROPRIATE OR IF SHE DOES NOT PARK IN THE DESIGNATED AREAS. In addition, chronic tardiness to school is a reason to have your parking privileges removed.

My daughter, _____, grade _____, hrmr. _____ has permission to drive to school and agrees to the above policy.

Parent/Guardian Signature

Student Signature

Vehicle 1- Car Make

Model

Color

License Plate #

SHA Tag # (office use)

Vehicle 2- Car Make

Model

Color

License Plate #

SHA Tag # (office use)

Date Issued (office use)

Rev. 6/28/16

- Please tear off the attached parking lot map for your reference -

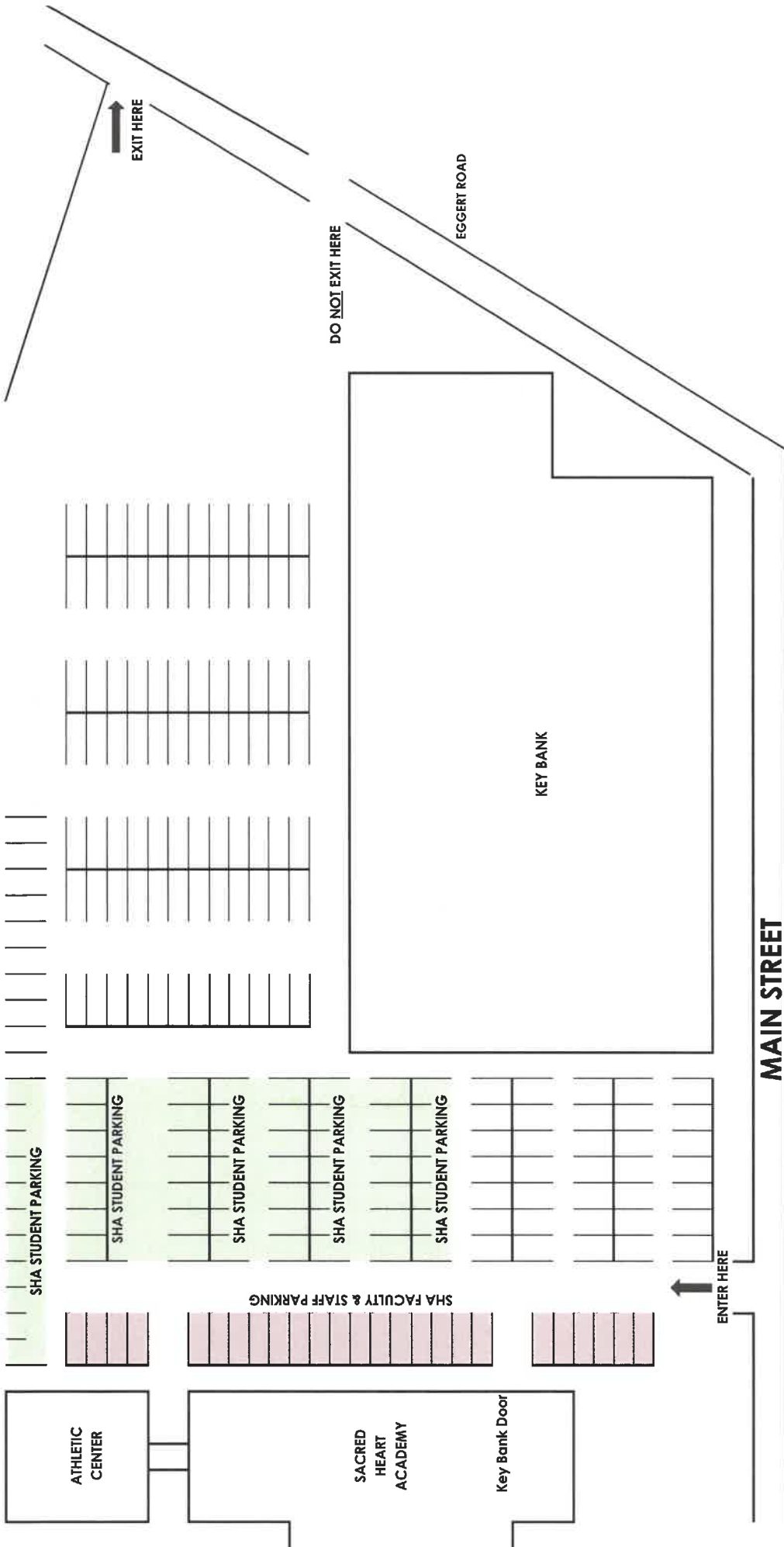

NOTE: This is an illustration of the parking lot. There are more spaces than shown in the approved student parking areas.

- 1 Please **ENTER** into parking lot from Main Street.
- 2 Please **EXIT** parking lot at Eggert Road side.
- 3 Students may park only in areas (green shaded) marked "SHA Student Parking."